

Miller WMA

OVERVIEW

The Miller Wildlife Management Area (WMA) sits 6 miles west of Sauk Centre along 430th St. The small WMA is mainly a brome grassland. **Small, low, wet areas dominated by cattails are found throughout the landscape.** The surrounding area complements the WMA with mostly undisturbed natural areas close by. Future work on the property will include **conversion from the brome grassland to native prairie.** With this project, emphasis will be put on creating a diverse grass and forb composition.

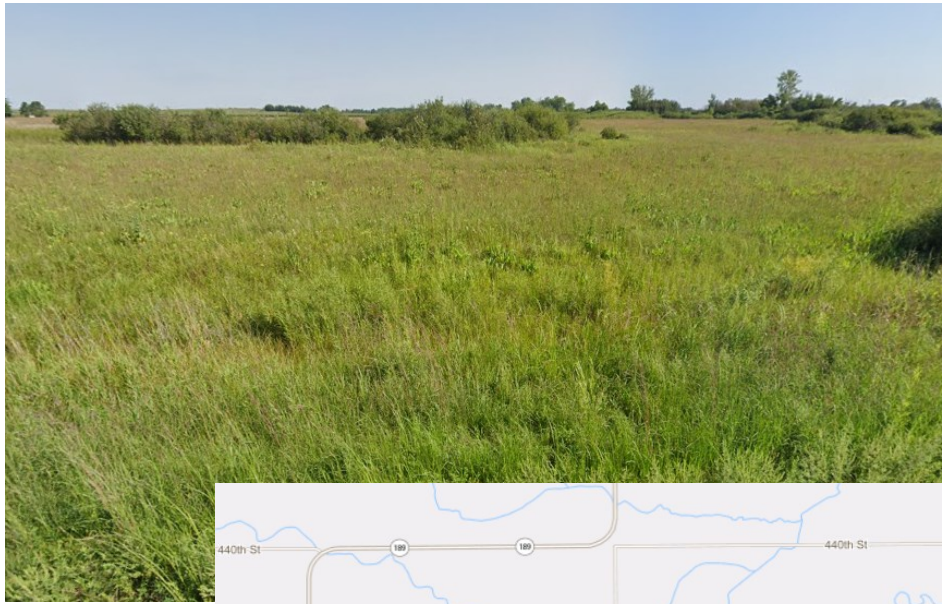

Miller WMA provides the opportunity for a variety of outdoor activities. Some of the most common uses are hunting, trapping, hiking and wildlife viewing. While visiting WMAs, respect private property boundaries and ask for permission before going onto private lands.

Game Species: Deer, Small Game, Pheasants

Area: 39.35 acres

Perimeter: 0.99 miles

County: Stearns

Near: Sauk Centre

Location: 45°44'48.5"N 95°05'27.6"W



Helpful Links

Click on each of the below links to go to relevant and specific information.

[DNR: Discover WMAs](#)

[DNR: Adopt a WMA](#)

