

Randall WMA

OVERVIEW

The Randall Wildlife Management Area (WMA) sits 4 miles northeast of Osakis on 170th St. The small WMA is located less than 0.5 miles east of the Sauk River. Randall Lake is just outside the WMA to the southeast. The landscape is wooded and features restored native grass field and adjacent cattail marsh. The management focus of this unit is to improve its woodland and grassland habitats.

Randall WMA provides opportunities for various outdoor activities. Some of the most common uses are hunting, trapping, hiking, and wildlife viewing/photography. Additional winter activities like cross-country skiing and snowshoeing are options as well! While visiting WMAs, respect private property boundaries and ask for permission before going onto private lands.

Game Species: Deer, Small Game, Pheasants, Waterfowl



Area: 58.21 acres

Perimeter: 1.57 miles

County: Todd

Near: Osakis

Location: 45°52'33.6"N 95°04'22.0"W

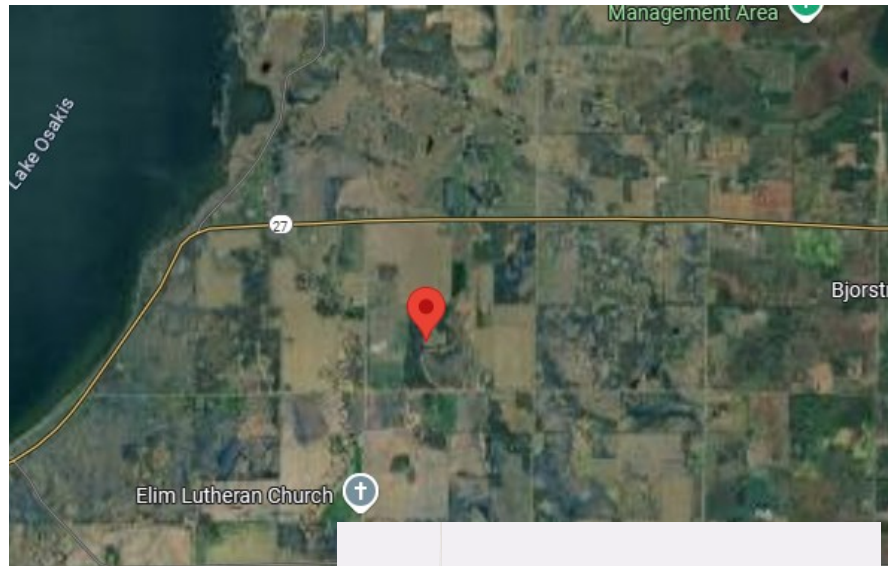

Helpful Links

Click on each of the below links to go to relevant and specific information.

[DNR: Discover WMAs](#)

[DNR: Adopt a WMA](#)

MPCA Surface Water:
[Randall Lake & Sauk River](#)

MPCA Water Quality Dashboard:
[Randall Lake & Sauk River](#)

